

**KENNEDY VALVE KS-FW
RESILIENT
WEDGE VALVES**

KENNEDY VALVE

**KENNEDY VALVE AWWA C509 Resilient Wedge Gate Valves
Meet or Exceed the Requirements of
AWWA Standard C509
UL-262/FM-1120/1130
ULC-Underwriters' of Canada**

Size Range	Water Working Pressure psi	Seat Test psi	Hydrostatic Shell Test psi
AWWA 2"-12"	250 Water Works	250 & 400	500
ULFM 4"-12"	200 Fire Protection	250 & 400	500

Available in either non-rising stem or outside screw & yoke.

Available End Connections & Size Range	Figure No. (STD)	Figure No. with Post Plate
Flg. End (NRS) 2" - 12"	8561A	8701A (3" - 12")
M.J. 2" - 12" (except 2 1/2")	8571	8071 (3" - 12")
Flg. & M.J. 3" - 12"	8572	8702 (3" - 12")
Push-on for PVC (SDR) 2" - 8"	8597	8597P (3" - 8")
Flg. End (OS & Y) 2 1/2" - 12"	8068A	N/A
M.J. for Tapping 4" - 12"	8950	8950P
Push-on for D.I. & C900 PVC 4" - 12"	8901	8901P
M.J. Cutting-in 4" - 12"	8576	8576P
Push-on D.I. X Flg. 4" - 12"	8902	8902P
Threaded 2" - 3"	8057	8057P (3" only)
Threaded (OS&Y) 2" - 3"	8067	

Accessories

Indicator Posts	Handwheels
"T" Handles	Extension Stems
Stem Guides	Floor Boxes
2" Sq. Operating Nuts	Chain Wheels
Floorstands (non-rising stem)	EPDM Wedges Available

2" size not UL Listed

LISTED



888H



APPROVED



Complies with applicable requirements of AWWA C509

2"-12" R/S VALVE
OS&Y MATERIAL LIST

KENNEDY VALVE MODEL KS-FW

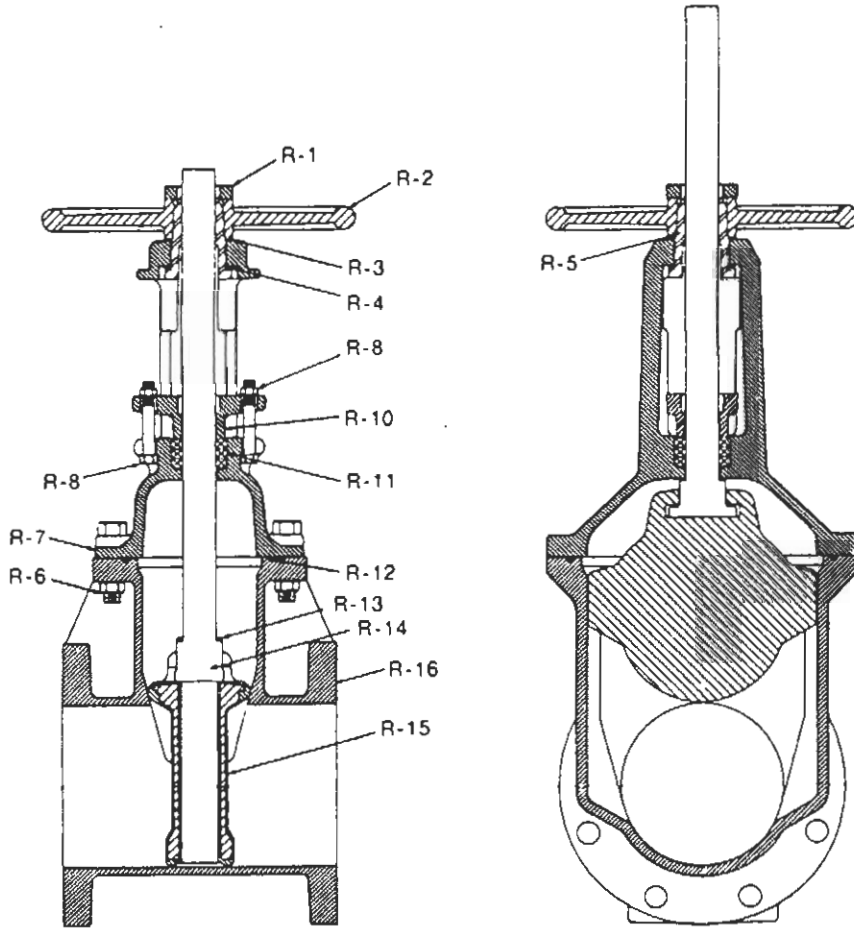

PIPE PLUG STANDARD ON FLANGE & GROOVE VALVES @ POSITION "A"

DET.	NAME OF PART	MATERIAL	ASTM SPEC.
R-1	Handwheel Nut	Bronze (AWWA Grade A)	ASTM B584 CDA 844
R-2	Handwheel	Cast Iron	ASTM A126 Class B
R-3	Upper Thrust Washer	Brass	ASTM B36 CDA 260
R-4	Lower Thrust Washer	Nylatron
R-5	Yoke Nut	Manganese Bronze	ASTM B584 CDA 862
R-6	Hex. Head Cover Bolts & Nuts	Zinc Plated Steel	ASTM A307/A563
R-7	Cover	Cast Iron	ASTM A126 Class B
R-8	Packing Bolts	Zinc Plated Steel	ASTM A307
R-8	Packing Bolt Nuts	Brass	ASTM A563
R-10	Packing Gland	Cast Iron	ASTM A126 Class B
R-11	Packing	Sq. Braided Non-Asbestos
R-12	O-Ring (Cover)	Buna - N
R-13	O-Ring (Stem)	Buna - N
R-14	Stem Assembly	Bronze	ASTM B584/B21
R-15	Wedge Disc	CI SBR Coated	ASTM 126 Class B
R-16	Body (All Types)	Cast Iron	ASTM 126 Class B
R-17	Pipe Plug: 1/2"; 2 1/2"-4"--3/4"; 6"-12"	Galvanized Steel

2 1/2" - 12" R/S GATE VALVE OS&Y ASSEMBLY EXPLOSION

KENNEDY VALVE MODEL KS-FW

DET.	QTY.	DESCRIPTION	MATERIALS
R-1	1	Handwheel Hold Down Nut	Bronze
R-2	1	Handwheel	Cast Iron
R-3	1	Upper Thrust Washer (Sizes 3" thru 12")	Bronze
R-4	1	Lower Thrust Washer	Bronze
R-5	1	Yoke Nut	Bronze
R-6	4	Cover Bolts & Nuts (Sizes 2-1/2" thru 6")	Zinc Plated Steel
R-6	8	Cover Bolts & Nuts (Sizes 8 thru 12)	Zinc Plated Steel
R-7	1	Cover	Cast Iron
R-8	2	Packing Bolts	Zinc Plated Steel
R-8	2	Packing Bolt Nuts	Brass
R-10	1	Packing Gland	Cast Iron
R-11		Packing	Sq. Braided Polymer
R-12	1	O-Ring (Cover)	NBR
R-13	1	O-Ring (Stem)	NBR
R-14	1	Stem Assembly	Bronze
R-15	1	Wedge Disc	Cast Iron SBR Coated
R-16	1	Body	Cast Iron
R-17	1	Pipe Plug	Galvanized Steel

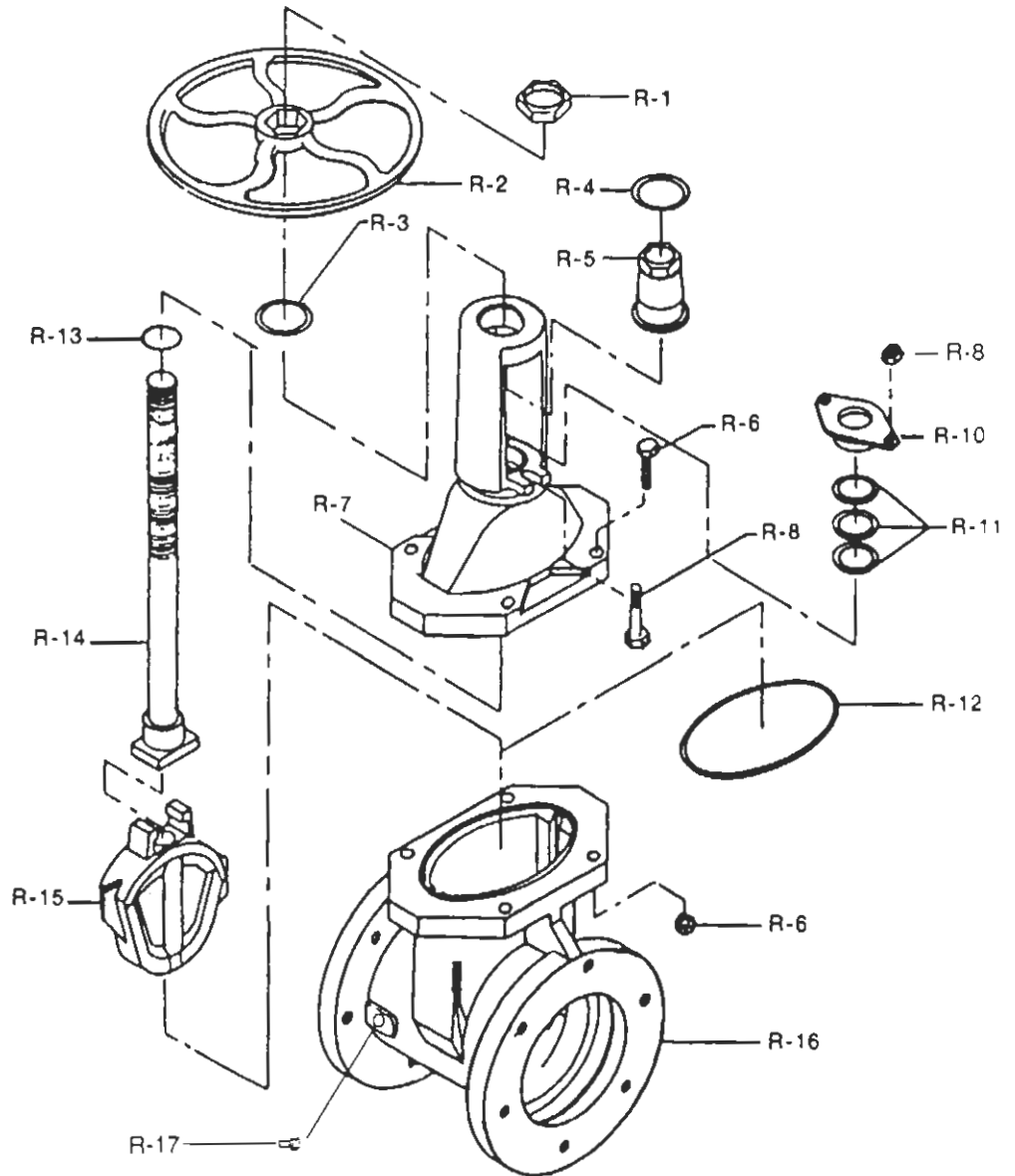

LISTED



Complies with applicable requirements of AWWA C509

**RESILIENT SEAT GATE VALVE
N.R.S. ASSEMBLY
KS-FW**

KENNEDY VALVE MODEL KS-FW

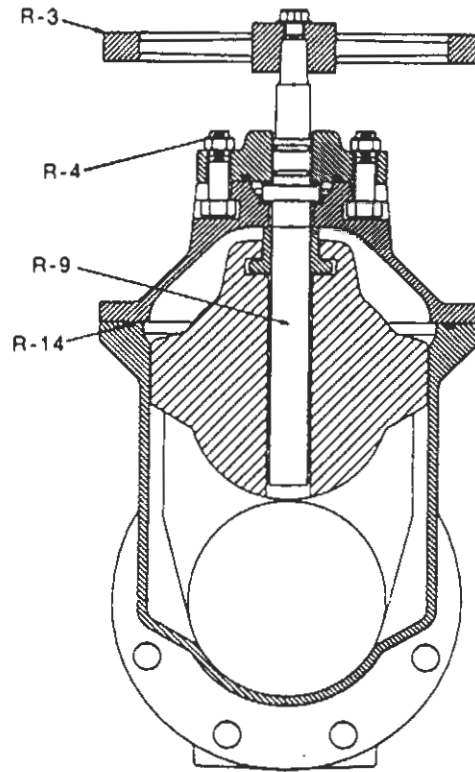
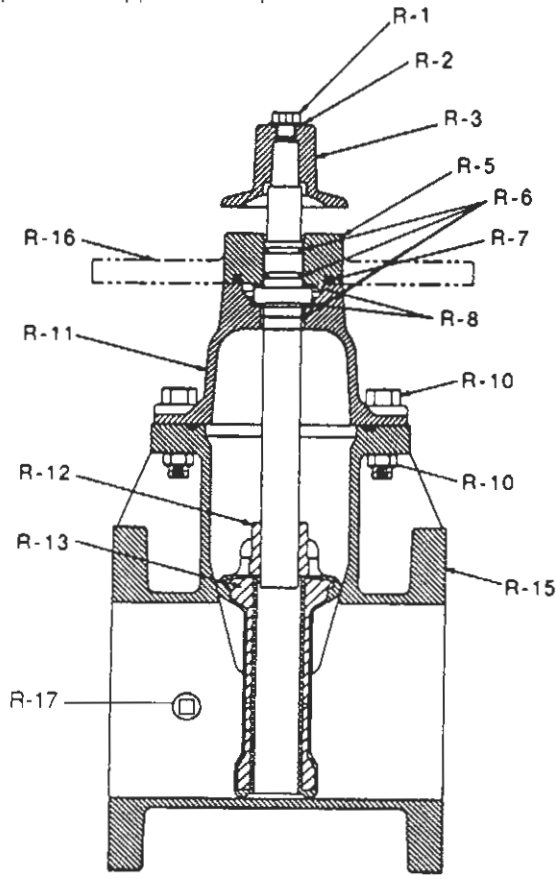

PIPE PLUG STANDARD ON FLANGE & GROOVE VALVES @ POSITION "A"

DET.	NAME OF PART		MATERIAL	ASTM SPEC.
R-1	Hex Head Bolt		Zinc Plated Steel	ASTM A307
R-2	Flat Washer		Zinc Plated Steel	ASTM A307
R-3	Operating Nut		Cast Iron	ASTM A126 Class B
	Handwheel		Cast Iron	ASTM A126 Class B
R-4	Hex Bolt & Nut		Zinc Plated Steel	ASTM A307/A563
R-5	Stuffing Box	2" thru 8"	Cast Iron	ASTM A126 Class B
		10" and 12"	Ductile Iron	ASTM A536 Gr. 65-45-10
R-6	O-Ring (Stem)		Buna - N	-----
R-7	O-Ring (Stuffing Box)		Buna - N	-----
R-8	Thrust Washer		Delrin	-----
R-9	Stem (AWWA Grade C)		Manganese Bronze	ASTM B584 CDA 867
R-10	Hex Head Cover Bolts & Nuts		Zinc Plated Steel	ASTM A307/A563
R-11	Cover		Cast Iron	ASTM A126 Class B
R-12	Stem Nut (AWWA Grade A)		Bronze (Low Zinc)	ASTM B584 CDA 844
R-13	Wedge Disc		C.I. SBR Coated	ASTM A126 Class B
R-14	O-Ring (Cover)		Buna - N	-----
R-15	Body (All Types)		Cast Iron	ASTM A126 Class B
R-16	Plate		Cast Iron	ASTM A126 Class B
R-17	Pipe Plug: 1/2"; 2 1/2"-4"--3/4"; 6'-12"		Galvanized Steel	-----

LISTED



2" - 12" GATE VALVE
NRS ASSEMBLY EXPLOSION

KENNEDY VALVE MODEL KS-FW

Complies with applicable requirements of AWWA C509

DET.	QTY.	DESCRIPTION	MATERIALS
R-1	1	Hold Down Hex Bolt	Zinc Plated Steel
R-2	1	Hold Down Bolt Washer	Zinc Plated Steel
R-3	1	Sq. Operating Nut OR Handwheel (Not Shown)	Cast Iron
R-4	2	Bolt & Nut (Stuffing Box)	Zinc Plated
R-5	1	Stuffing Box (10" & 12" D.I.)	Cast Iron
R-6	3	O-Ring (Stem) 1 Below Collar	NBR
R-7	1	O-Ring (Stuffing Box)	NBR
R-8	1	Thrust Washer (Sizes 2"-2 1/2")	
	2	Thrust Washer (Sizes 3" thru 12")	Delrin
R-9	1	Stem	Bronze
R-10	4	Cover Bolts & Nuts (Sizes 2" thru 6")	Zinc Plated
	8	Cover Bolts & Nuts (Sizes 8" thru 12")	Zinc Plated
R-11	1	Cover	Cast Iron
R-12	1	Stem Nut	Bronze
R-13	1	Wedge Disc	Cast Iron SBR Coated
R-14	1	O-Ring (Cover)	NBR
R-15	1	Body	Cast Iron

