



86B-500 Series

3-Piece Full Port Stainless Steel Class 600 Butt-Weld Ball Valve

Standard Compliance - Valve design: ASME B16.34, Class 600, End Connections: Butt-weld per ASME B16.25, Valve Marking: ASME B16.34, Production Testing: ASME B16.34, NACE MR0175, 2000 edition.

FEATURES

- 3-Piece construction w/ enclosed fasteners
- Full port
- Stainless steel trim & hardware
- Swing-out center section
- Pressure balanced solid ball
- Compression controlled spiral wound gaskets
- Anti-blowout one piece bottom entry stem
- Statically grounded ball, stem, & body
- Two-position locking
- Adjustable multi-piece PTFE "V" style packing
- Fully machined ISO 5211 mounting
- Cast bosses on the centersection and end caps for bleed & drain ports
- Vacuum service to 29 in of Hg.
- CE mark, 1-1/4" and larger

STANDARD MATERIAL LIST

| | | | |
|-----------------|-------------------|----------------------|----------------------------|
| 1. Body | ASTM A351-CF8M | 10. Body Nuts | ASTM A194-Gr.8 |
| 2. End Caps | ASTM A351-CF3M | 11. Stop Bolts | 18-8 Stainless Steel |
| 3. Ball | ASTM A276-316SS | 12. Gland Bolts | ASTM A193-Gr.B8 |
| 4. Stem | ASTM A276-316SS | 13. Handle Nut/Screw | 300 Series Stainless Steel |
| 5. Seat | Multi-Seal | 14. Packing Gland | ASTM A276-316SS |
| 6. Packing | PTFE | 15. Gland Plate | 300 Series Stainless Steel |
| 7. Stem Bearing | PEEK/PTFE | 16. Lever Handle | 300 Series Stainless Steel |
| 8. Body Gasket | PTFE Spiral Wound | 17. Lock Plate | 300 Series Stainless Steel |
| 9. Body Bolts | ASTM A193-Gr.B8M3 | 18. Stops | 300 Series Stainless Steel |
| | | 19. Int. Gmd. Spring | 300 Series Stainless Steel |
| | | 20. Ext. Gmd. Spring | 300 Series Stainless Steel |

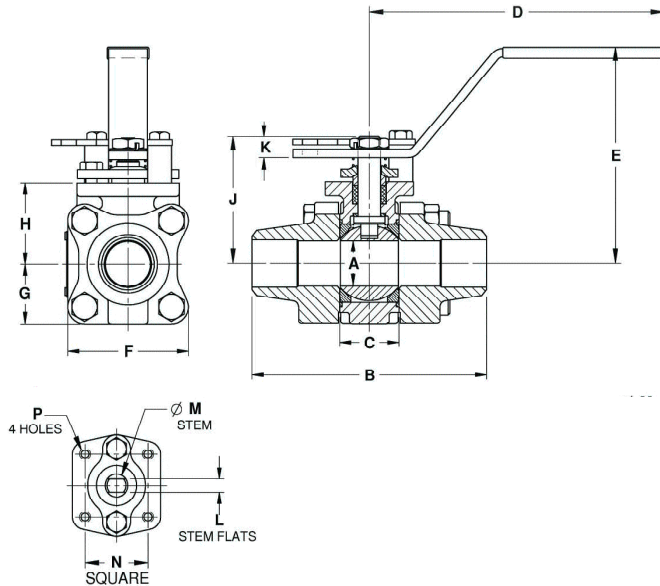

VARIATIONS AVAILABLE:

- 86B-300 - Schedule 5 Butt-weld
- 86B-400 - Schedule 10 Butt-weld
- 86B-600 - Schedule 80 Butt-weld

OPTIONS AVAILABLE:

| (SUFFIX) | OPTION | SIZES |
|----------|--|------------|
| -04- | 2-1/4" Stem Extension | 3/8" to 2" |
| -14- | Vented Ball (see page J-2) | 3/8" to 2" |
| -15- | Round Handle | 3/8" to 2" |
| -21- | UHMWPE Seats w/Graphite Seals | 3/8" to 2" |
| -24- | Fire Safe - Graphite Packing & Gaskets (API 607, 5th ed., ISO 10497-5) | 3/8" to 2" |
| -49- | Assembled Dry | 3/8" to 2" |
| -57- | Cleaned for Oxygen Service | 3/8" to 2" |
| -69- | Drilled & Tapped Purge & Drains | 3/8" to 2" |
| -70- | Extended Bonnet | 3/8" to 2" |
| -76- | Live Loaded (Lever Operated) | 3/8" to 2" |
| -77- | Live Loaded (Actuated) | 3/8" to 2" |

**For Pressure/Temperature Ratings,
Refer to Page M-18, Graph No. 26**

STAINLESS STEEL 3-PIECE FULL PORT BALL VALVE

| NUMBER | SIZE | A | B | C | D | E | F | G | H | J | K | L | M | N | P | WT. |
|------------|--------|------|------|------|------|------|------|------|------|------|------|-------|-------|-------|---------|------|
| 86B-502-01 | 3/8" | .50 | 3.80 | 0.89 | 5.12 | 3.02 | 2.02 | 1.01 | 1.39 | 1.97 | 0.23 | 0.245 | 0.375 | 1.00 | 10-24 | 2.3 |
| 86B-503-01 | 1/2" | .50 | 3.80 | 0.89 | 5.12 | 3.02 | 2.02 | 1.01 | 1.39 | 1.97 | 0.23 | 0.245 | 0.375 | 1.00 | 10-24 | 2.3 |
| 86B-504-01 | 3/4" | 0.75 | 4.66 | 1.10 | 5.53 | 3.40 | 2.40 | 1.20 | 1.65 | 2.35 | 0.24 | 0.312 | 0.500 | 1.392 | 1/4-20 | 4.0 |
| 86B-505-01 | 1" | 1.00 | 5.19 | 1.31 | 6.53 | 4.80 | 2.67 | 1.34 | 1.80 | 2.80 | 0.48 | 0.287 | 0.500 | 1.392 | 1/4-20 | 5.7 |
| 86B-506-01 | 1-1/4" | 1.50 | 5.48 | 1.97 | 6.65 | 4.70 | 3.84 | 1.92 | 2.49 | 3.89 | 0.72 | 0.412 | 0.625 | 1.949 | 5/16-18 | 14.2 |
| 86B-507-01 | 1-1/2" | 1.50 | 5.96 | 1.97 | 6.65 | 4.70 | 3.84 | 1.92 | 2.49 | 3.89 | 0.72 | 0.412 | 0.625 | 1.949 | 5/16-18 | 14.4 |
| 86B-508-01 | 2" | 2.00 | 6.84 | 2.56 | 8.40 | 5.47 | 4.92 | 2.46 | 3.17 | 4.74 | 0.80 | 0.477 | 0.750 | 1.949 | 5/16-18 | 27.6 |

**ASME Class 600 Carbon Steel
3 Piece Ball Valve
(Graph 25)**

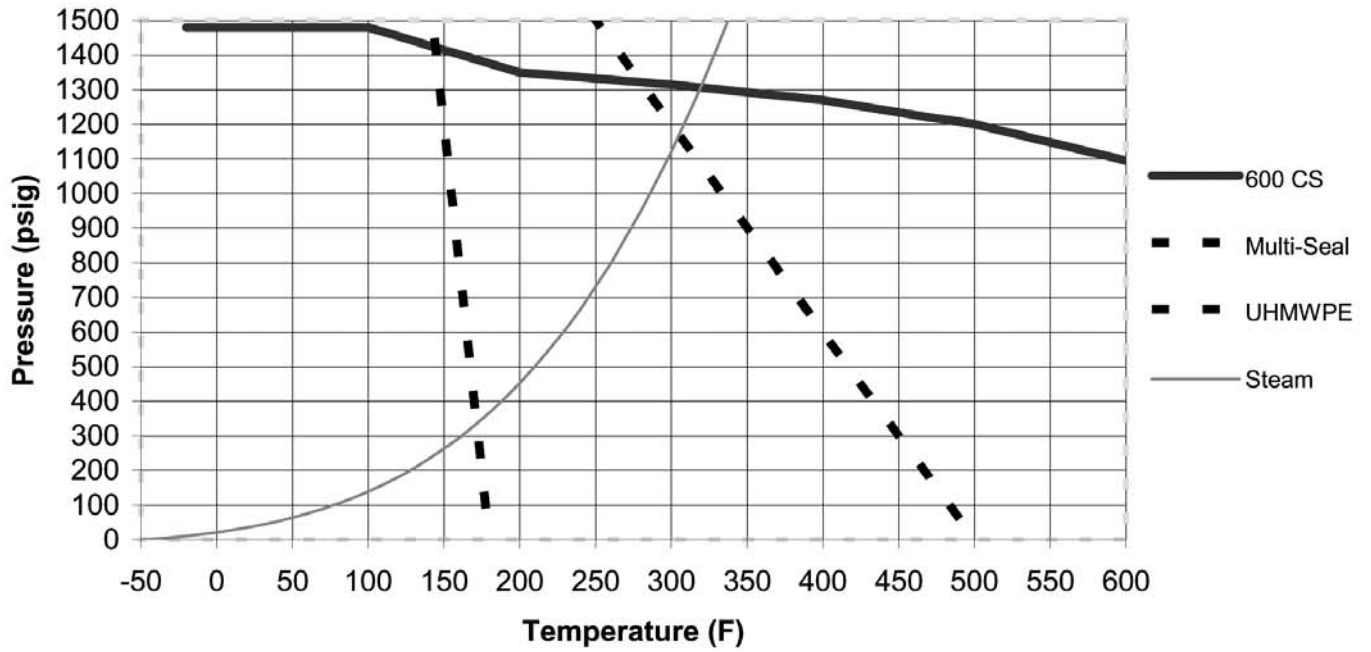

**ASME Class 600 Stainless Steel
3 Piece Ball Valve
(Graph 26)**

